

සබරගමුව පළාත් අධ්‍යාපන දෙපාර්තමේන්තුව
Sabaragamuwa Provincial Department of Education

පළමු වාර පරීක්ෂණය 2018
1st Term Test 2018

11 ශ්‍රේණිය
Grade 11

තොරතුරු හා සන්නිවේදන තාක්ෂණය
Information and Communication Technology

පැය එකයි
One hours

- Answer all the questions.
- For questions 1 – 40, select the correct answer or the most appropriate answer out of four answers given.

- 1) Give the correct definition of Data and Information.
 - A. In order to get Information Data should be processed
 - B. The value of the Information remain stable with the time
 - C. Today's rainfall is an example for InformationWhich is the correct answer from given statements,
 - i. only A
 - ii. A, B and C
 - iii. A and B
 - iv. C only
- 2) What is the generation that used the Keyboard to input Data
 - i. First Generation computers
 - ii. Second Generation computers
 - iii. Third Generation computers
 - iv. Fourth Generation computers
- 3) What are the examples for systems that we are using in day today life
 - i. Automated Teller Machine(ATM), QR Code
 - ii. Magnetic Resonance Imaging Machine(MRI) ,Computerized Axial Tomography CAT)
 - iii. Radio Frequency Identification Device (RFID), Closed Circuit TV(CCTV)
 - iv. Computerized Axial Tomography (CAT), Automated Teller Machine (ATM)
- 4) What is the Port that you are using to connect your Laptop to school computer network
 - i) PS/2 port
 - ii) Serial Port
 - iii) Parallel Port
 - iv) Network Port

5) 5. Consider the following devices,

- a. Joy stick
- b. OMR
- c. Light Pen
- d. Printer

Select the Pointing device and the Scanning device respectively

- i) a and d
- ii) a and c
- iii) a and b
- iv) c and b

6) What is not an example for Volatile memory

- i) Cache Memory
- ii) Memory Card
- iii) RAM
- iv) Memory Register

7) What is the equivalent Hexadecimal number for the octal number 123_8

- (i) 53_{16}
- (ii) 42_{16}
- (iii) 63_{16}
- (iv) $7B_{16}$

8) 27_x , here 'x' is the base of the given number. Which are the all bases reliable for 'x'

- (i) Decimal, Binary, Octal
- (ii) Binary, Octal, Hexadecimal
- (iii) Decimal, Binary, Hexadecimal
- (iv) Decimal, Octal, Hexadecimal

9) A – 151 B - 10011001_2 C – $8F_{16}$ D - 230_8

According to A,B,C, and D, What is the Correct Ascending order

- (i) A , B , C , D
- (ii) B , C , A , D
- (iii) C , A , D , B
- (iv) B , D , A , C

10) According to ASCII coding system if the letter "H" represent by the binary value 1001000_2 . The letter "K" is representing for,

- (i) 1110101_2
- (ii) 1001101_2
- (iii) 1001011_2
- (iv) 1101010_2

11) The following picture shows the process of operating a bulb using a battery and two switches.

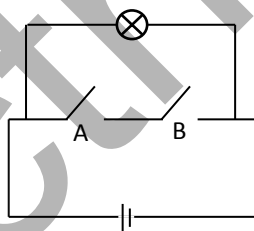

Figure 1

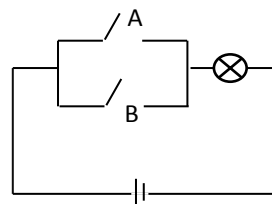
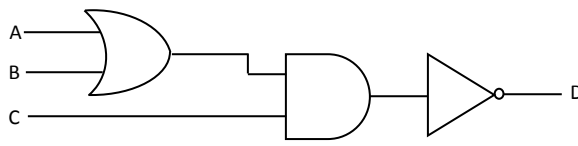

Figure 2

According to the above circuit diagrams what is the correct order which shows the logicgates for above diagrams.

- (i)
- (ii)
- (iii)
- (iv)

12) If output of the logic circuit is 1 what are the input values which can be taken for A, B and C



- (i) A = 1 B = 1 C = 1
- (ii) A = 1 B = 0 C = 1
- (iii) A = 0 B = 1 C = 0
- (iv) A = 0 B = 1 C = 1

13) P, Q and R are 3 questions in a question paper. Applicants must answer 2 questions. The question P is compulsory. Applicants have to select one question from Q and R Which is the Boolean statement for the above statement

- 1) P AND (Q AND R)
- 2) P OR (Q OR R)
- 3) P AND (Q OR R)
- 4) P OR (Q AND R)

14) What is not an utility programme in the OS?

- 1) Disk Partitioning
- 2) Disk Formatting
- 3) Compiler
- 4) Defragmentation

15) Consider the following statements regarding Operating Systems.

- a. Safety management is the task of OS
- b. Android OS is a production of Apple co-operation
- c. Multi user OS are used in Super Computer

Which of the above is/are correct

- i) a, b only
- ii) b, c only
- iii) a, c only
- iv) a, b, c all

16) CLI Stands for"

- 1) Command Letter Interface
- 2) Computer Line Interface
- 3) Command Line Interface
- 4) Computer Letter Interface

17) Commercial Software and Free and Open source software- (FOSS) are used For Word Processing. But word processing can be done without installing such type software. Which of the following is an example for non-installing word processing software.

- 1. Open office.writer
- 2. Word Perfect
- 3. Google Docs
- 4. Ms Word

18) In a word document the word latter" is typed instead of the word "letter" what is the easiest way to correct the mistake.

- 1) Spelling & Grammer
- 2) Find & Replace
- 3) Auto Correct
- 4) Delete & Retype

19) By using "X²" icon in a word document

1. Indentation can be done
2. Super Script can be done
3. Grow Font can be done
4. Right Alignment can be done

20) What is the reason to demonstrate the symbol "####" in an electronic spreadsheets

- 1 mistake of a formula
- 2 Not enough space in a column
- 3 when the formula is too long
- 4 Non above the all

21) The following chart shows the discounts of the goods in the "Sena Stors". According to the given discount of "C001" the available discount should be included in the "D5" cell. What is the formula for "D5". (It can be copied for the other items)

	A	B	C	D	E
1					
2		Sena stors			
3		Discount =			10%
4		Item	Price	Discount	
5		C001	\$1,500.00		
6		C002	\$3,000.00		
7		C003	\$1,250.00		

1 =C5*E3

2 =\$C\$5*E5

3 =D5*E\$3

4 =C5*E\$3

22) Consider the following cell address

- A. E\$5\$ B. \$E\$5 C. \$5E\$ D. E\$5

Which of the above addresses are correct

- i. B
- ii. B and C
- iii. B and D
- iv. Non above the all

23) Rusiru has used different types of Text and Graphics for his E-Presentation. He wants to use animation for his Text and Graphics. What is the tool can be used.

1. Slide transition
2. Drawing toolbar
3. Custom animation
4. Layouts

24) What is the tool which can be used to rearrange the Slides in electronic presentation

- i. Normal
- ii. Slide Show
- iii. Slide sorter
- iv. Handout

25) Which of the following statements is correct regarding Presentation software

- 1 Sound clip can be inserted, Movie clip can't be inserted
- 2 Movie clip can be inserted, Sound clip can't be inserted
- 3 Movie clip and Sound clip can't be inserted
- 4 Movie clip and Sound clip can be inserted

26) In a presentation what is the way of moving to another slide

- 1) Slide transition
- 2) Slide layout
- 3) Slide design
- 4) Button

• Answer the questions 27-29 using the following table

Patient

Patient_ID	Patient_Name	DOB	
P100	Sarath	1975.12.06	
P101	Padmini	1968.06.15	
P102	Rajapaksha	1964.02.18	

Doctor

Doctor_ID	Doctor_Name
D08	Dr. Namal
D08	Dr. Ruwan
D08	Dr. Rathnayaka

27) What is the relationship among Doctor table and Patient table

- 01 One-to-one Relationship
- 02 Many-to-many Relationship
- 03 One-to-many Relationship
- 04 Many-to-one Relationship

28) How many Fields are used to store data in Doctor table

- i) 3
- ii) 4
- iii) 2
- iv) 6

29) How many records are used to store data in Doctor table

- i) 3
- ii) 4
- iii) 2
- iv) 6

30) In order to certify the identification of an employee, what is the strategy of DBMS

- 1 Table
- 2 Query
- 3 foreign
- 4 primary key

31) Which of the following statement is correct regarding "Function" and "Procedure" in computer programming

- i) Programmes are easier
- ii) Editing can be done easily
- iii) Without changing or with a simple change, can be used for another place
- iv) All above are correct

32) The Algorithm is

- 1 It's a Computer Language
- 2 It's a Operating System
- 3 step-by-step procedure for solving a problem.
- 4 It is a Computer Code

33) Consider the following Data types, The data type of 6.5 and 15

- A. Byte
- B. Integer
- C. Long
- D. Single
- D. Double

Which are the data type of 6.5 and 15

- (i) A ,B & C,D,E
- (ii) A ,D & B,C,E
- (iii) D ,E & A,C,B
- (iv) C ,D,E & A,B

34) 34 Consider the given Pseudo code Output is

BEGIN	
P=5	1. 5
R=8	2. 13
If(P>R)	
Display P	3. 8
Else	
Display R	4. error
END	

35) The Debugging is

- I. Modifying the instructions
- II. Assembling the computers
- III. Identify the incorrect instructions
- IV. Running the Instruction

36) Var : Array[0..5] of integer is an array" What is the lenth of "Var : Array[0..5] of integer"

- i) 5
- ii) 6
- iii) 4
- iv) Non above the all

37) Which of the following is incorrect regarding “while do structure

```
Number := 1;
While numbr <= 10 do
    Number := number + 1;
```

- I. When do the repetition 1 is added to the number every time
- II. The started value of the ‘number’ variable is 1, So the statement is true
- III. The value of the ‘number’ variable is 10, The repetition is stopped.
- IV. The programme runs 10 times

38) Which are the steps given respectively for the System Development Life Cycle

- i. System Planning, System Analyze, System Development, Testing, Deployment of the system, Maintenance
- ii. System Analyze, System Planning, Software development, Testing, Deployment of the system, Maintenance
- iii. System Planning, Developing, Testing, Activating, Maintenance
- iv. System Analyze, System Planning, System Development, Deployment of the system, Maintenance, Testing

39) Which is the incorrect statements regarding “ System”

- i. The System has input output arrangement
- ii. There is a limitation of the system
- iii. There is an aim for the system
- iv. The system is always computerized

40) Transaction procession System) is most useful for

- I. Customers
- II. Low level mangers
- III. Middle level managers
- IV. High level mangers